



## CN4 - Lincat Silverlink 600 Free-standing Ambient Open-Top Pedestal without Doors - W 450 mm

Designed to suite with other products in the Silverlink 600 range, the Pedestal's adjustable shelf provides flexibility for storing bulky items.

- ✔ Designed to suite with the Silverlink 600 range
- ✔ Silverlink 600 counter-top units are securely attached to pedestals by means of fixing screws supplied
- ✔ Adjustable shelf provides flexibility for storing bulky items
- ✔ Adjustable feet for alignment even on uneven floors

### Specifications

#### Summary

<b>Brand</b>	Lincat
<b>Range</b>	Silverlink 600
<b>Unit Type</b>	Free-standing
<b>Available in UK Only</b>	No
<b>UK Warranty</b>	2 Years Parts and Labour Warranty
<b>Export Warranty</b>	Contact your local dealer
<b>GTIN</b>	5056105100850

#### Weights and Dimensions

<b>Unit Height (External) mm</b>	660
<b>Unit Width (External) mm</b>	450
<b>Unit Depth (External) mm</b>	600
<b>Height (Internal) mm</b>	456
<b>Width (Internal) mm</b>	448
<b>Depth (Internal) mm</b>	567
<b>Shelf Dimensions Width mm</b>	400
<b>Shelf Dimensions Depth mm</b>	530
<b>Net Weight Kg</b>	14.3

#### Shipping

<b>Packed Weight Kg</b>	15.73
<b>Packed Height cm</b>	74.5
<b>Packed Width cm</b>	71.5
<b>Packed Depth cm</b>	53

### Available Accessories

<b>PSH4</b>	450 PEDESTAL SHELF
-------------	--------------------

### Technical Picture

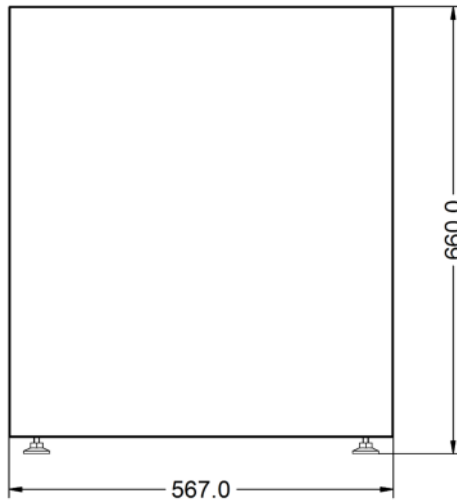
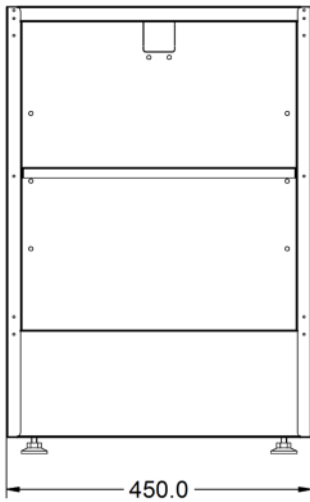
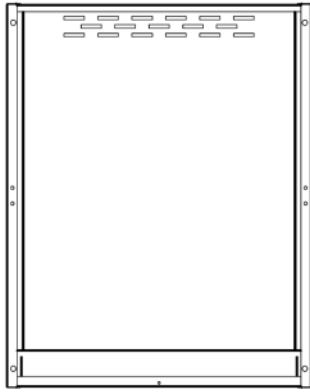

#### Lincat Limited

Whisby Road,  
Lincoln, LN6 3QZ,  
United Kingdom

**Company No:** 2175448

A member company of



#### Customer Care

**Tel:** +44 1522 875500  
**Email:** care@lincat.co.uk

#### Export Customers

**Tel:** +44 1522 875536  
**Email:** export@lincat.co.uk

#### Opening Hours

**Monday – Friday:**  
8.30am – 5pm